

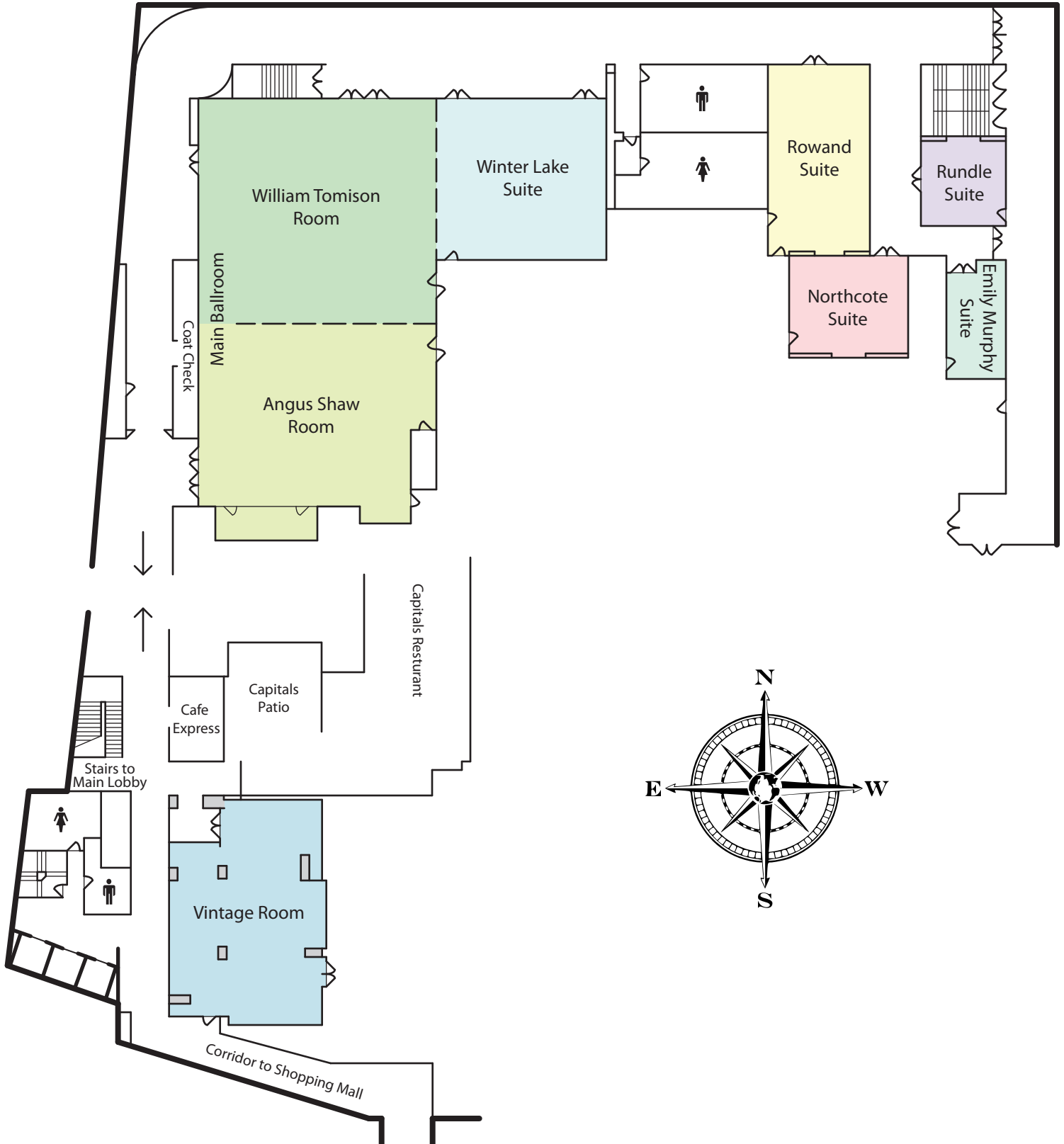

The Sutton Place Hotel
EDMONTON

Meeting & Banquet Rooms

Second Floor



Main Ballroom Room

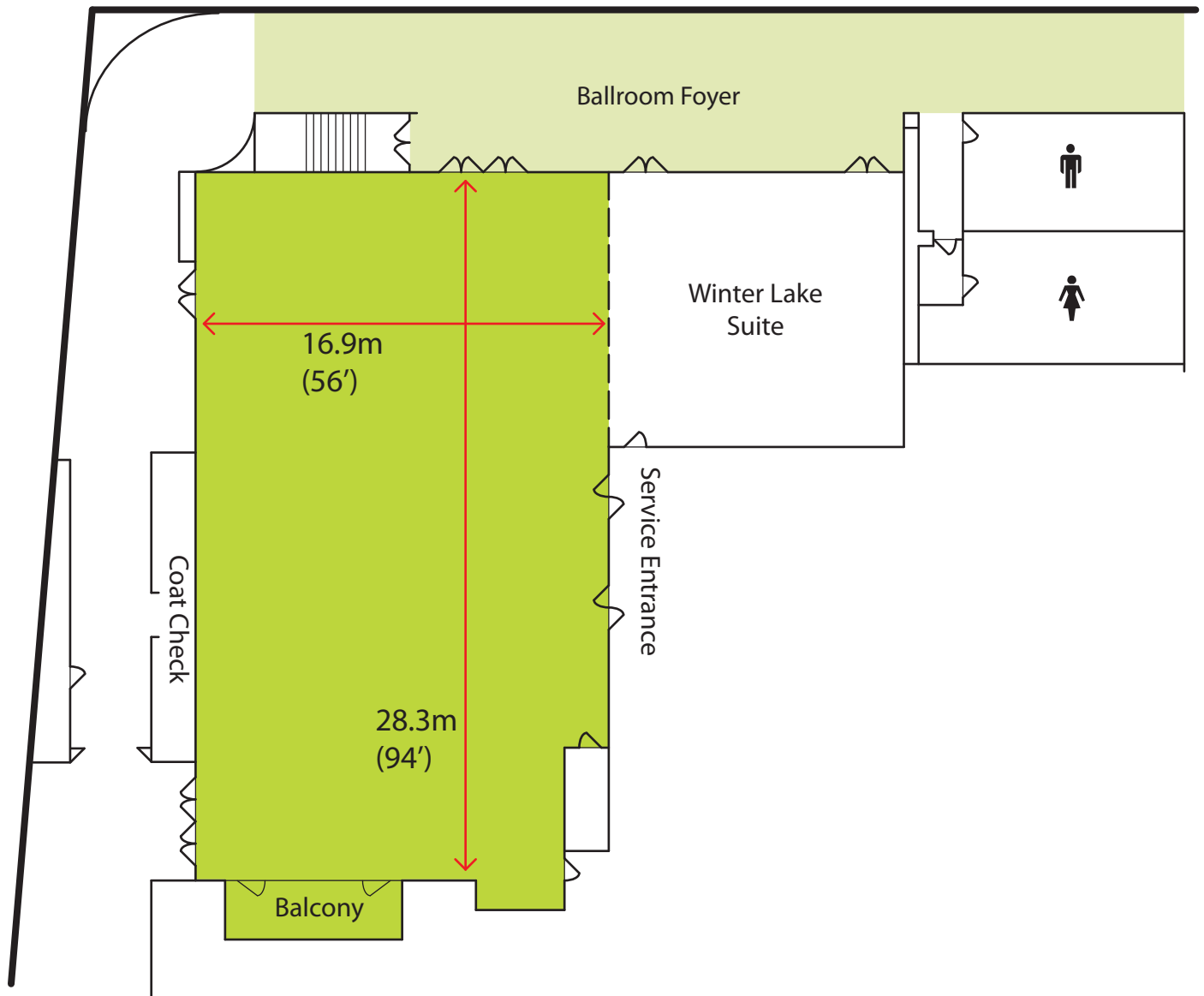

Style	Capacity
Classroom	300
Theatre	600
Banquet	380
Reception	600
Foyer	180

Dimensions	28m x 17m 94' x 56'
Ceiling Height	3.78m 12'5"

*Foyer is reception style only

**Ballroom can also be combined with Winter Lake Suite

Angus Shaw Room

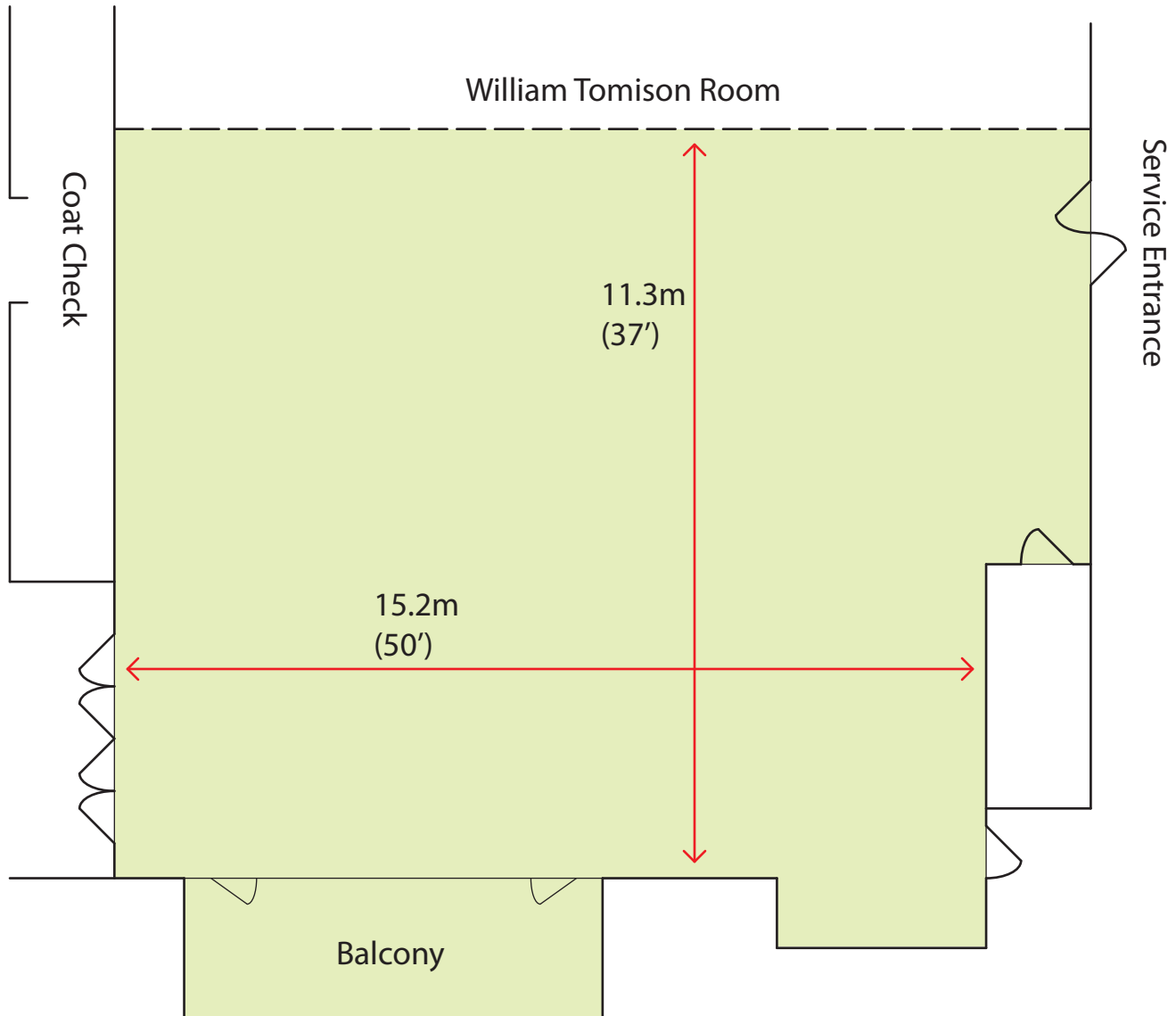

Style	Capacity
Classroom	80
Theatre	200
Banquet	150
Reception	200

Dimensions	15m x 11m 50' x 37'
Ceiling Height	3.78m 12'5"

*Angus Shaw Room can be combined with William Tomison Room

William Tomison Room

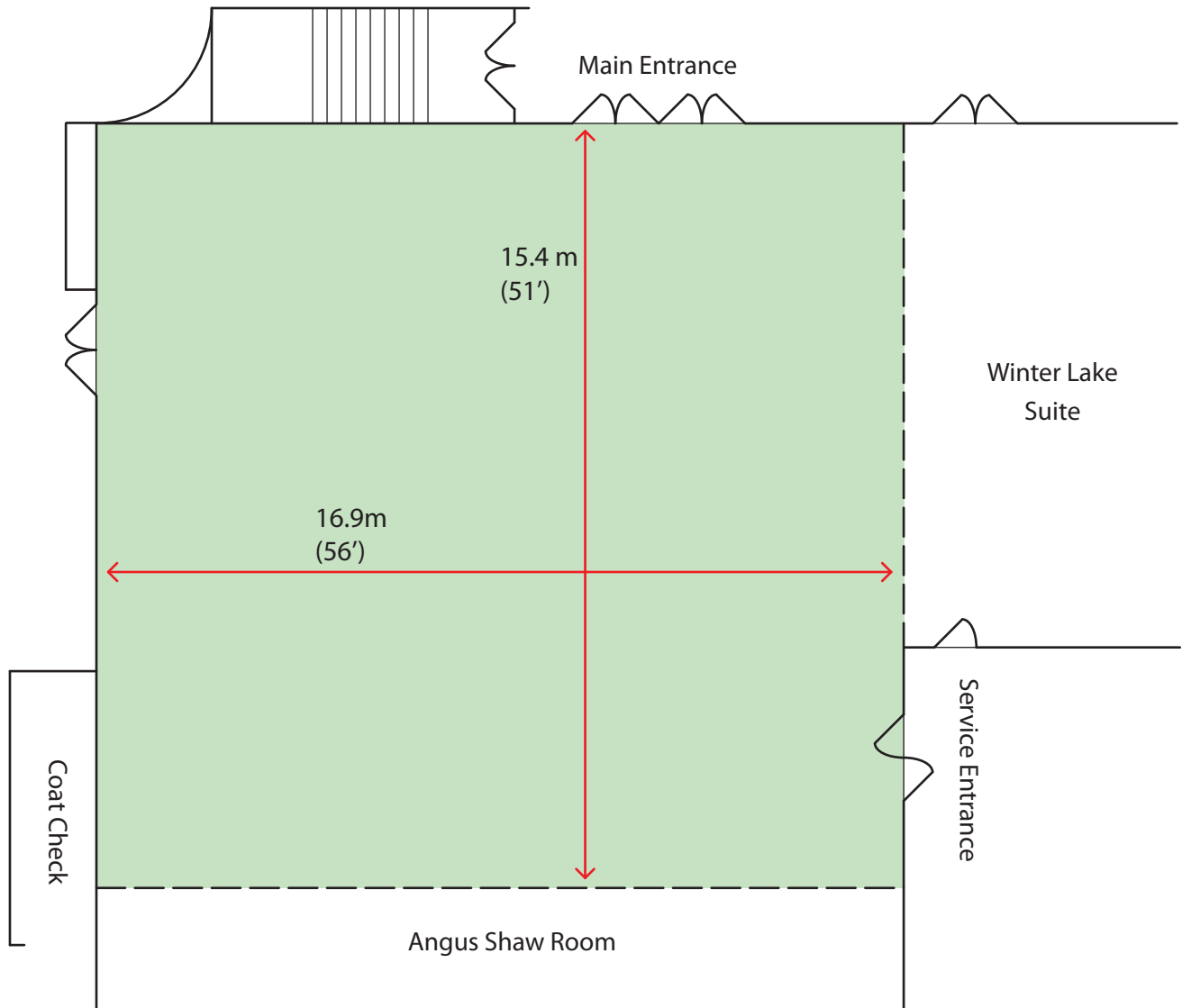

Style	Capacity
Classroom	140
Theatre	300
Banquet	200
Reception	350

Dimensions	15m x 17m 51' x 56'
Ceiling Height	3.78m 12'5"

*William Tomison Room can be combined with Winter Lake Suite and/or Angus Shaw Room

Winter Lake Suite

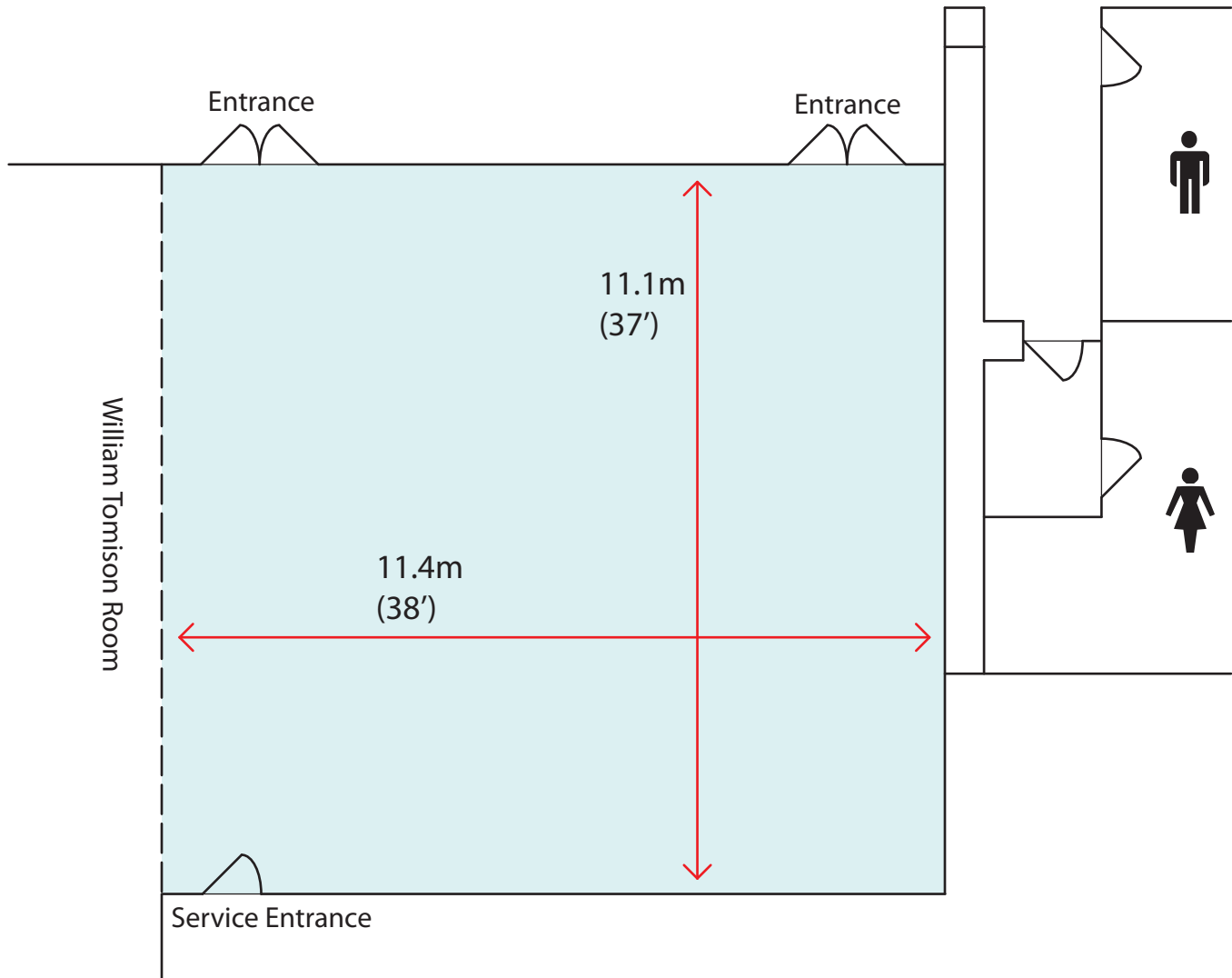

Style	Capacity
Classroom	50
Theatre	120
Banquet	80
Reception	100

Dimensions	11m x 11m 38' x 37'
Ceiling Height	3.48m 11'5"

*Winter Lake Suite can be combined with William Tomison Room

Rowand Suite

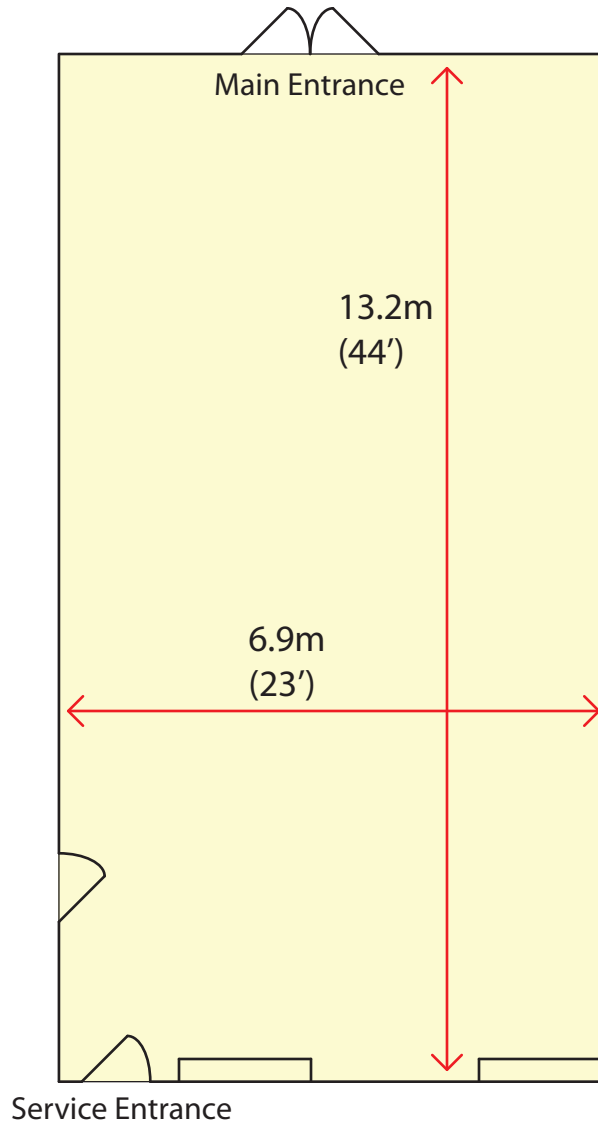

Style	Capacity
Classroom	40
Theatre	80
Banquet	70
Reception	80

Dimensions	13m x 7m
	44' x 23'
Ceiling Height	3.0m
	10'

Rundle Suite

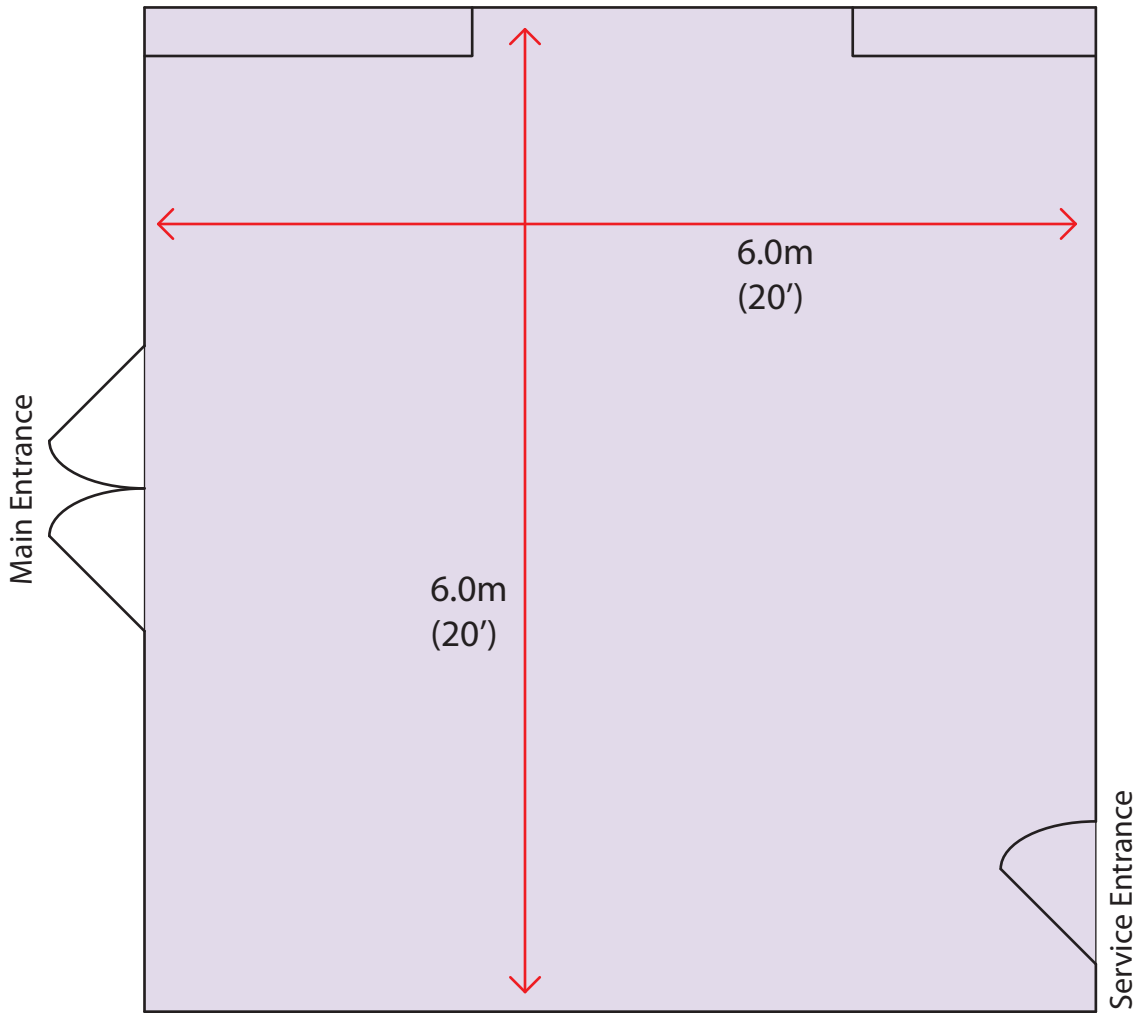

<u>Style</u>	<u>Capacity</u>
Classroom	16
Theatre	40
Banquet	30
Reception	40

Dimensions	6m x 6m
	20' x 20'
Ceiling Height	3.6m
	12'

Emily Murphy Suite

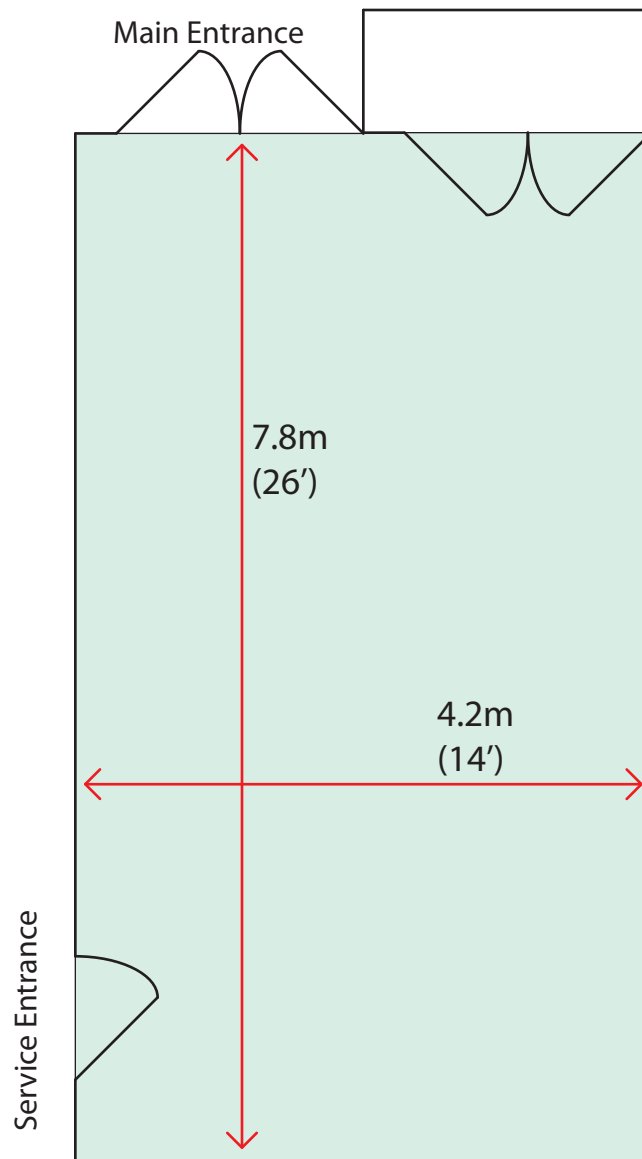

Style	Capacity
Classroom	12
Theatre	20
Banquet	20
Reception	20

Dimensions	7.8m x 4.2m 26' x 14'
Ceiling Height	3.0m 10'

Northcote Suite

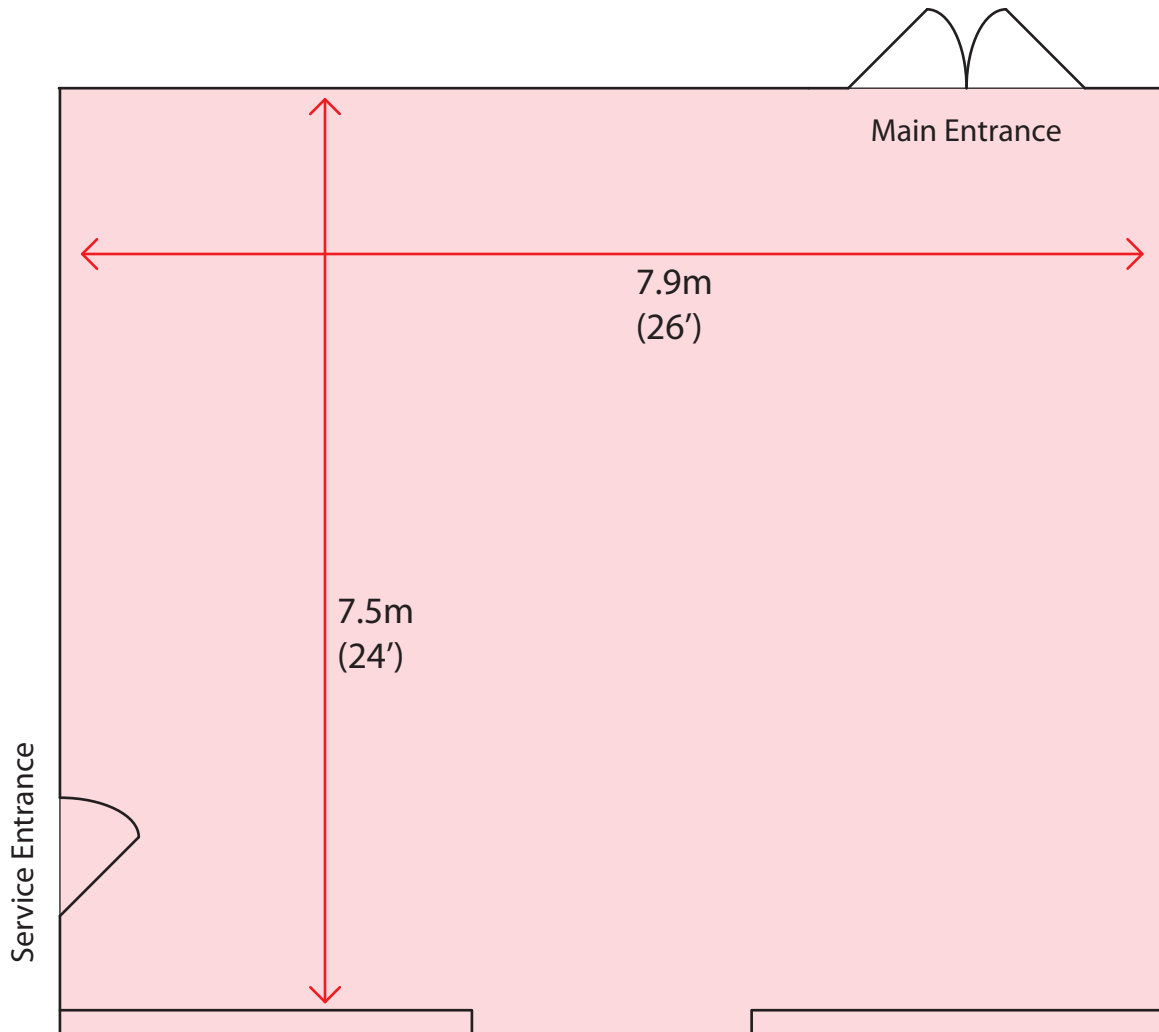

Style	Capacity
Classroom	30
Theatre	40
Banquet	40
Reception	50

Dimensions	7.9m x 7.5m 26' x 24'
Ceiling Height	3.0m 10'

Vintage Room

